

1	6HP Engine (EX 17)	6200900
2	Velt 13 x 800	3601299
3	Drive Shaft Pulley	461464
4	Drive Shaft (Petrol)	461878
5	Drive Shaft Bearing Ext.	461843
6	5/16 UNF x 1 Screw & Spring Washer	Standard
7	Belt Guard	461370
8	Rear Cover	461480
9	Drive Shaft Key	HD 657109
10	Ball Bearing	1128382
11	40mm INT. Circlip	Standard
12	Woodruff Key	3802051
13	M 12 Flat Washer	Standard
14	1/2" UNF Nut	Standard
15	Bearing Extrension Support	461448
16	Drive Shaft Cover (Not Shown)	461995

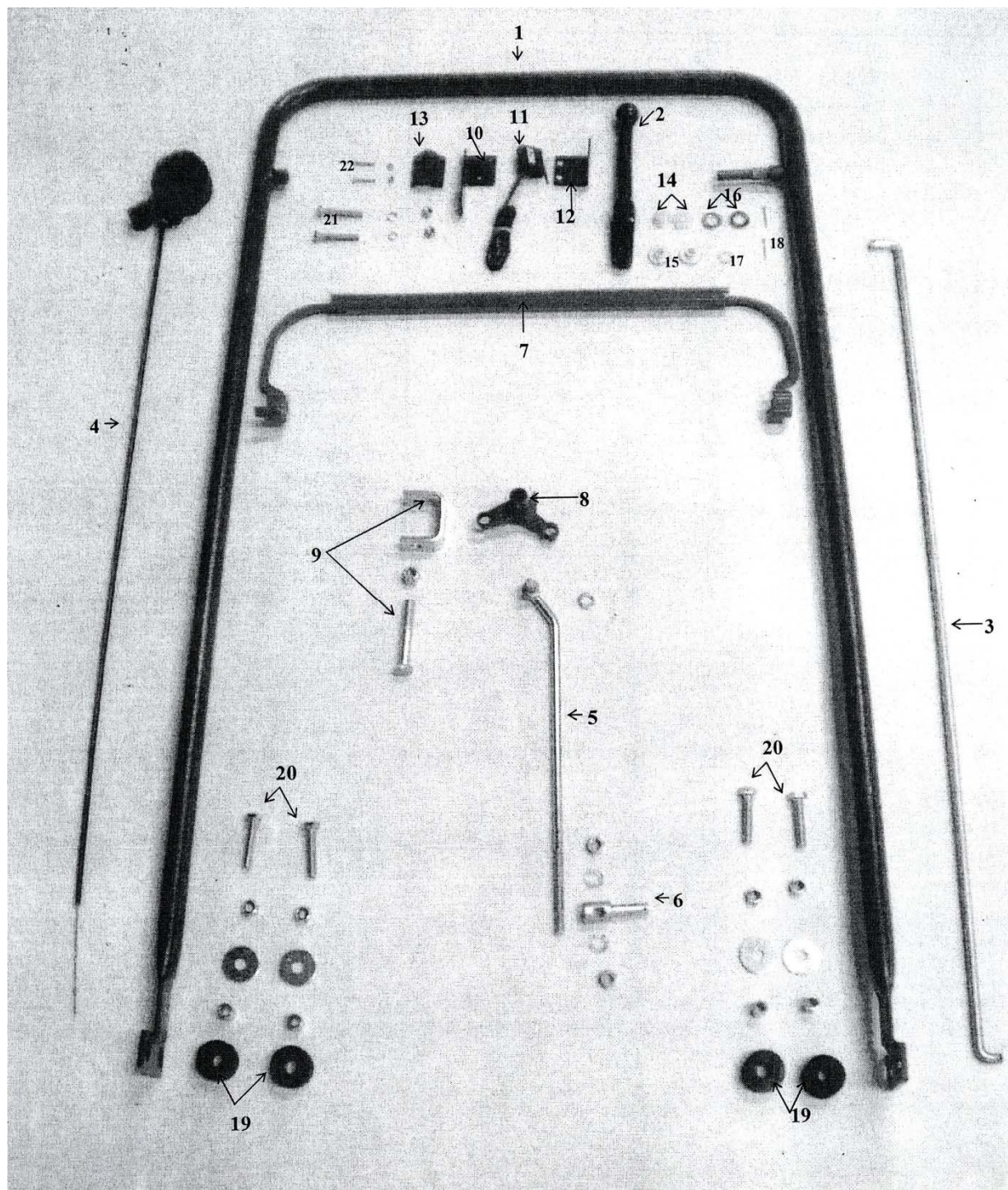

1	Handle: Export	461540
2	Control Lever	BG 305475
3	Control Rod	461333
4	Jockey Pulley Control Rod (with 8mm nuts & washers)	466286
5		461190
6	Control Rod Pivot	461350
7	Bale Bar	467050
8	Inter Control Lever	461552
9	Inter Lever Bracket & 3/8 UNF x 2" Bolt & Nut	461181
10	Bale Bar Stop	461958
11	Micro Switch Burgees	HD 1671900
12	Micro Switch Top Bracket	461989
13	Micro Switch Bottom Bracket	461987
14	Nylon Bush 10 DIA	461990
15	Nylon Bush 8 DIA	461991
16	M10 Flat Washer	Standard
17	M 8 Flat Washer	Standard
18	3mm Split Pin	Standard
19	Antivibration Mount with Bush	SI 458050
20	M8 x 40 Bolt/Nut/Washer	Standard

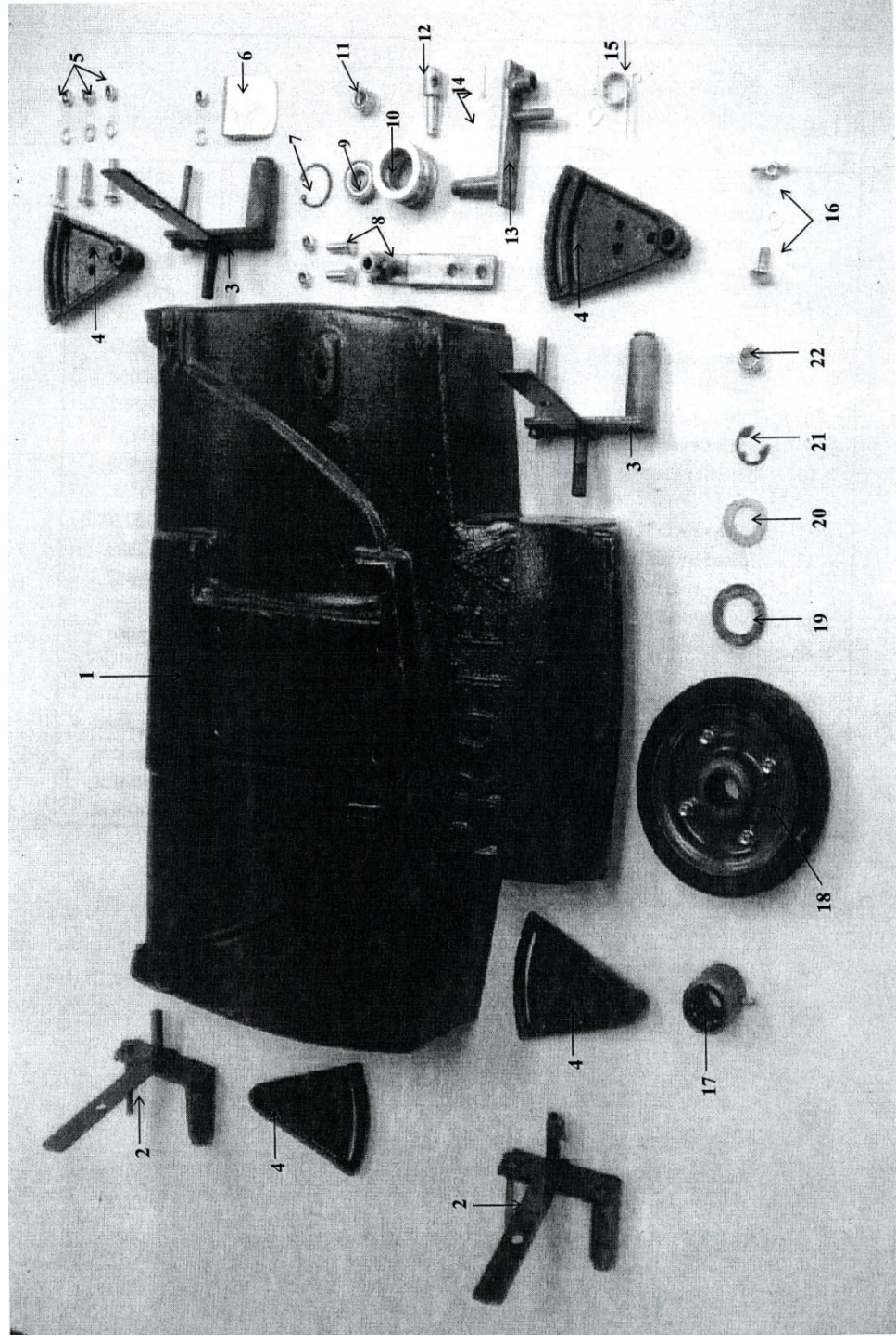

		NO.
1	Body	461018
2	LH Adjuster Lever	461974
3	RH Adjuster Lever	461982
4	Wheel Quadrant	461026
5	Quadrant Bolt/Nut/Spring Washer M8 x35	Standard
6	Mud Scraper	461704
7	INT Circlip M35	Standard
8	Jockey Arm Assy. With M8 x 25 Screw & Nyloc Nut	461229
9	Jockey Pulley Bearing	1126226
10	Jockey Pulley	451560
11	Jockey Pulley Lock Nut 1/2" UNF	Standard
12	Control Rod Pivot	461350
13	Jockey Fulcrum Bracket	461296
14	M3 Split Pin & M 10 Flat Washer	Standard
15	Jockey Arm Spring	461270
16	Carriage Bolt & Wing Nut For Adjuster Lever	
17	Wheel Bearing	
18	Weel Complete	6361583
19	Wheel Shim Washer M25	Standard
20	Circlip Waher M20	Standard
21	Circlip	1502012
22	Nylon Lock Nut 1/2 UNF	Standard

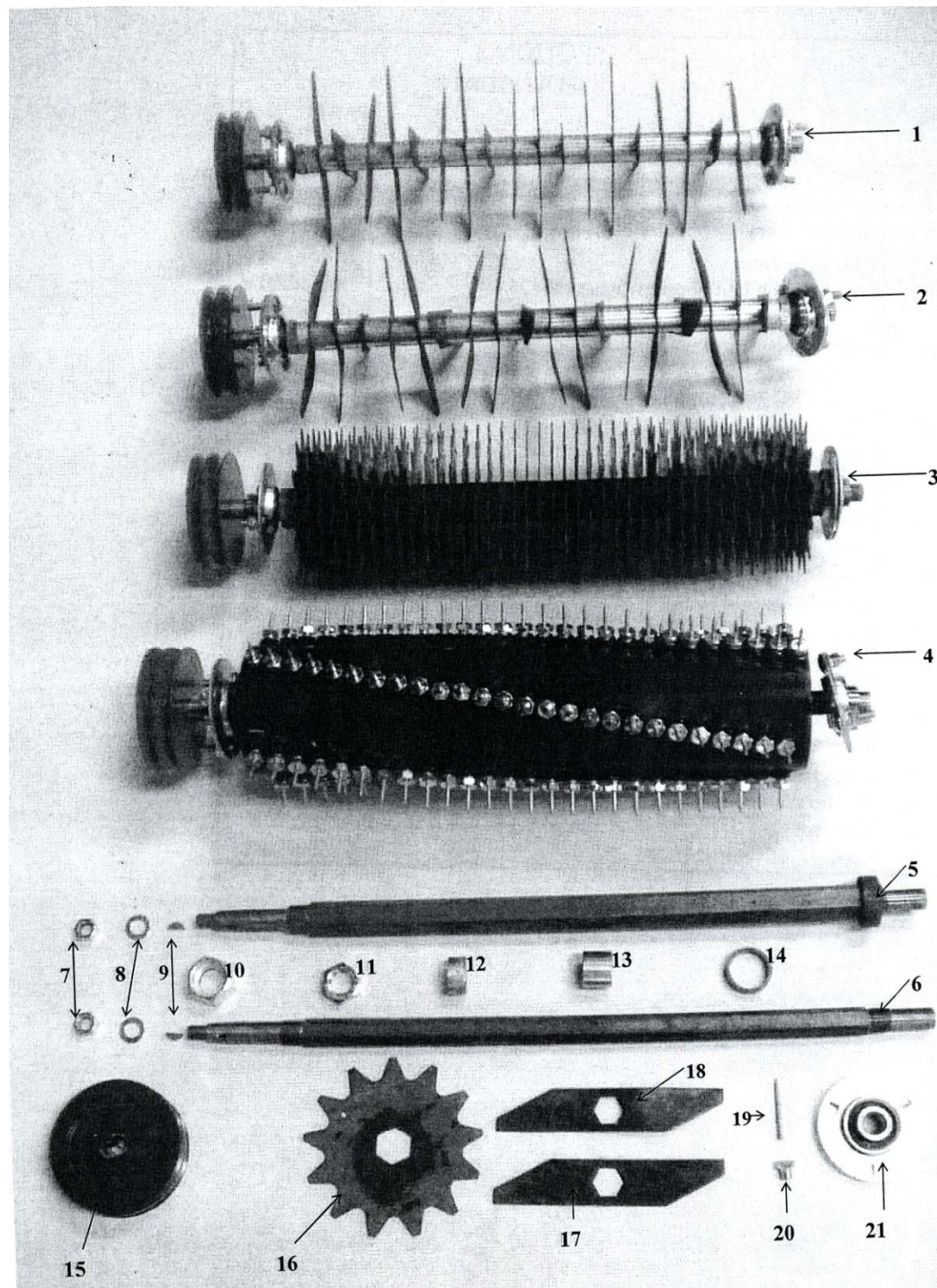

1	Verticut Reel Assy (18 Straight Blades)	460200
2	Scarifier Reel Assy (18 Offset Blades)	460103
3	Groomer Reel Assy (41 Blades)	460197
4	Pin Type Reel Assy (130 Pins)	460198
5	Groomer Reel Shaft	461956
6	Scarifier/Verticut Reel Shaft	461149
7	Shaft Lock Nut 1/2" UNF	Standard
8	M12 Sping Washer	Standard
9	Woodruf Key	3802051
10	Groomer Blade Lock Nut	461955
11	Verticut/Scarifier Blade Lock Nut	2441303
12	Verticut/scarifier End Blade Spacer	461165
13	Verticut/scarifier Blade Spacer	461659
14	Groomer Blade Spacer	5306082
15	Shaft Pulley	461173
16	Groomer Blade	5306081
17	Verticut Blade Straight	461640
18	Scarifier Blade (Offset)	461130
19	Scarifier Nail	2441305
20	Scarifier Nail Bolt	461957
21	Shaft Bearing	1721010